



**monroe**

a brand of aebi schmidt

**2023**

# Ford E-350 Cat Cage Installation S.W.P

Monroe Truck Equipment

8/24/23

 **aebi schmidt**  
group

# Cat Cage Installation 2023

Compatible with Ford E350

## Tool/Parts Required

- Ratchet or ratchet wrench
- Vice grips or needle nose pliers
- Anti-seize lubricant

## Included with Kit (00207239)

1. Lower Guard Cat (1)
2. Upper Guard Cat (1)
3. Front Bracket (1)
4. Rear Bracket (1)
5. Spanner insert bit (1)
6. 5/16" x 1" SS Bolt (12)
7. 3/8" x 1" SS Bolt (3)
8. 5/16" Nylock nut (6)
9. 3/8" Nylock nut (3)
10. 5/16" Flat washer (18)
11. 3/8" Flat washer (6)

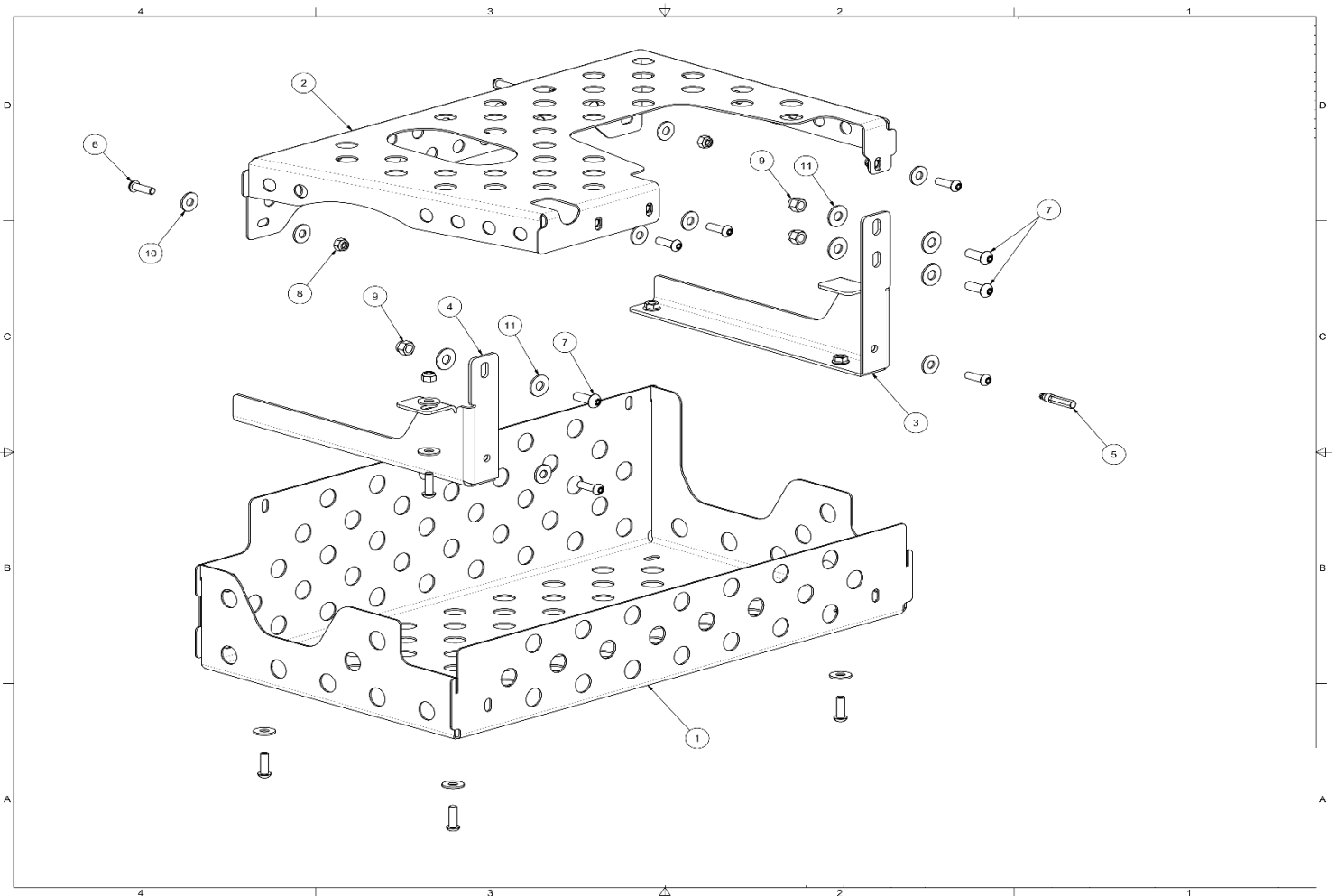



Standard Work  
Procedure

## Installation Procedure

- A. Place the front bracket behind the cabin on the passenger side. Bolt front bracket using 3/8" hardware. See Figure 1.
  - a. Move ground cable out of the way to place bracket on chassis.



Figure 1

- B. Place the rear bracket on the frame so it is 22" center to center from the front bracket. See Figure 2

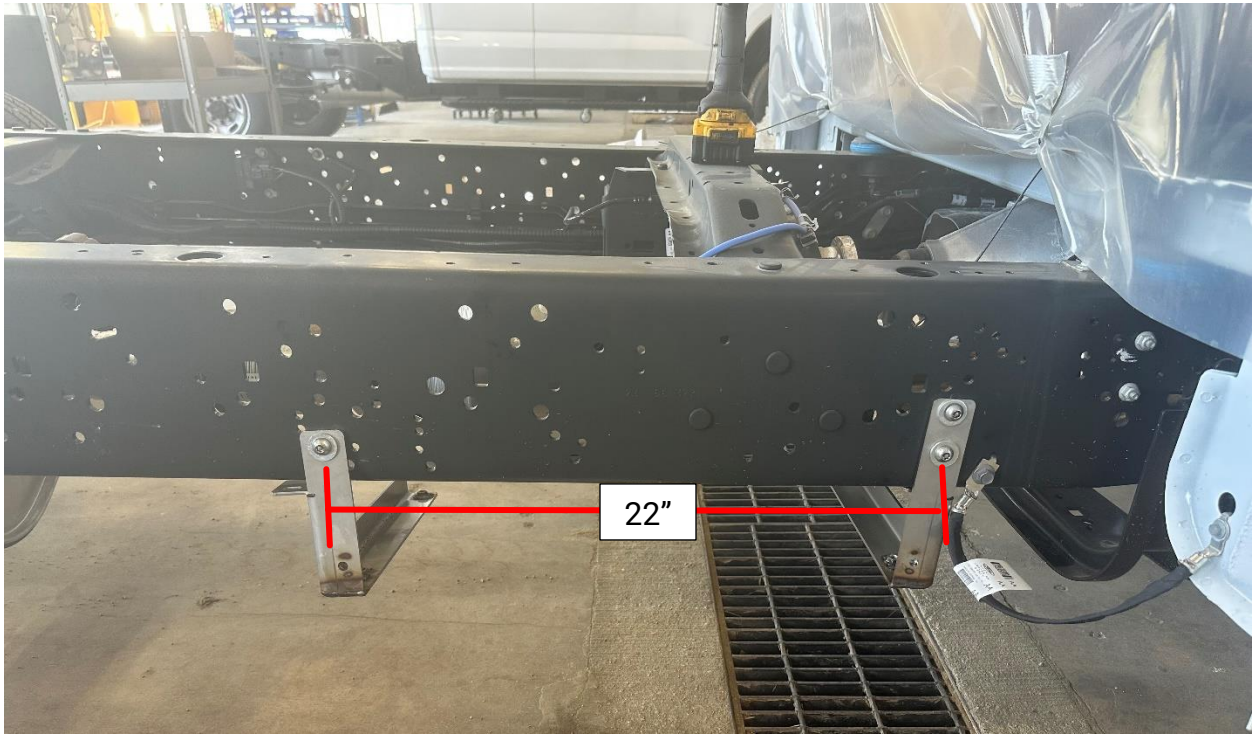

Figure 2

C. Using the 5/16" hardware, bolt brackets as seen below. See Figure 3.

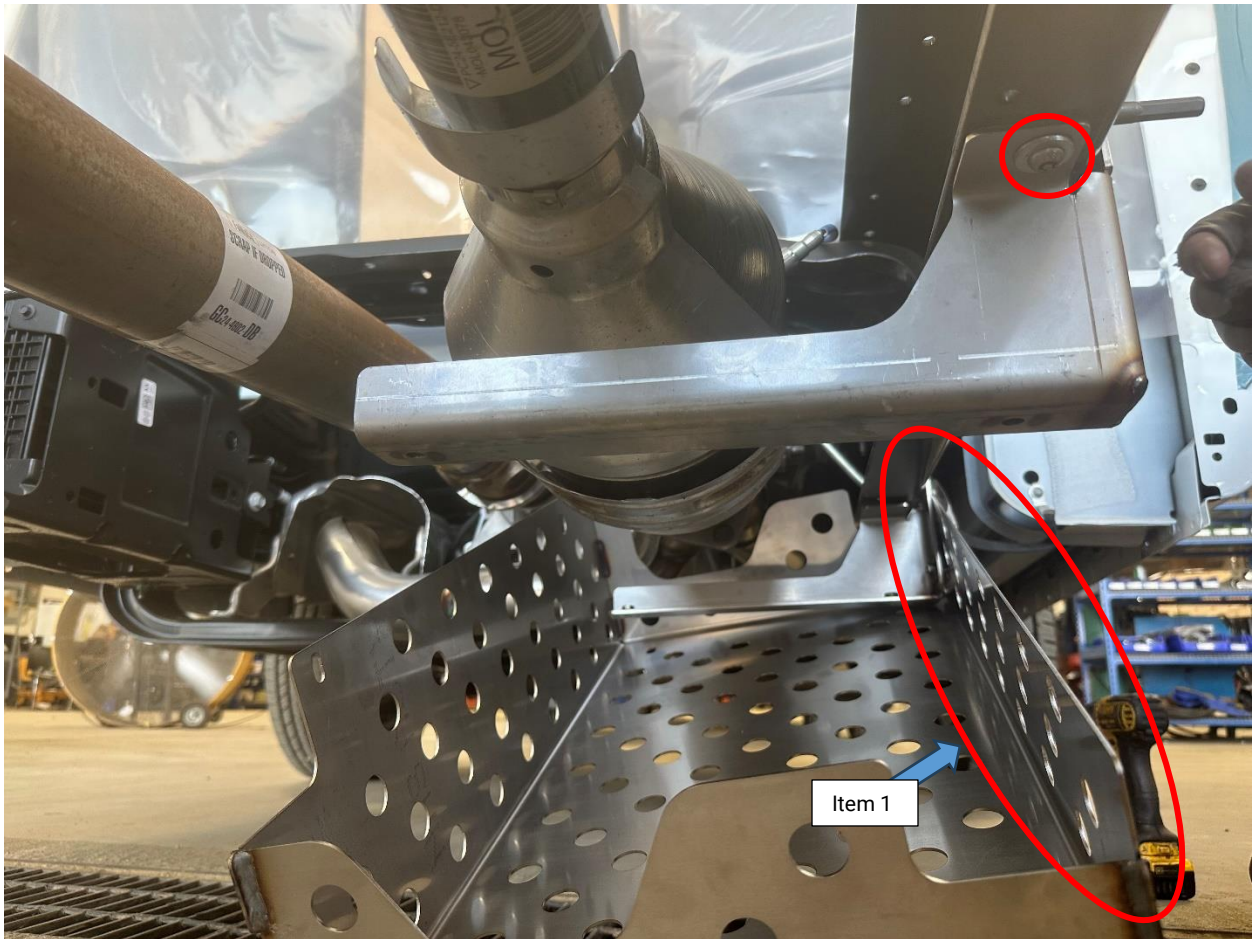

Figure 3

D. Place the lower cat guard under the catalytic and position the flat face facing the passenger side. See Figure 3 Item 1.

- E. Using the 5/16" hardware, lift the guard into place lining up the slotted holes with the holes on the brackets and bolt it. See Figure 4.

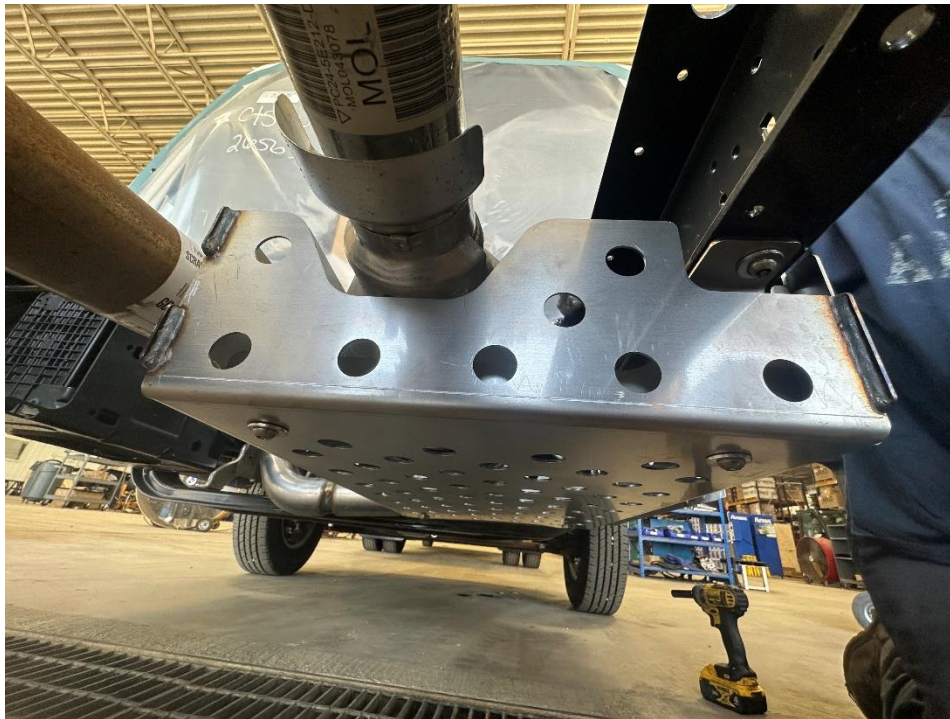

Figure 4

- F. Pass the upper guard over the driveshaft and set it between the cross member and the catalytic converter. Bolt it to lower guard and chassis. See Figure 5, Figure 6, and Figure 7.

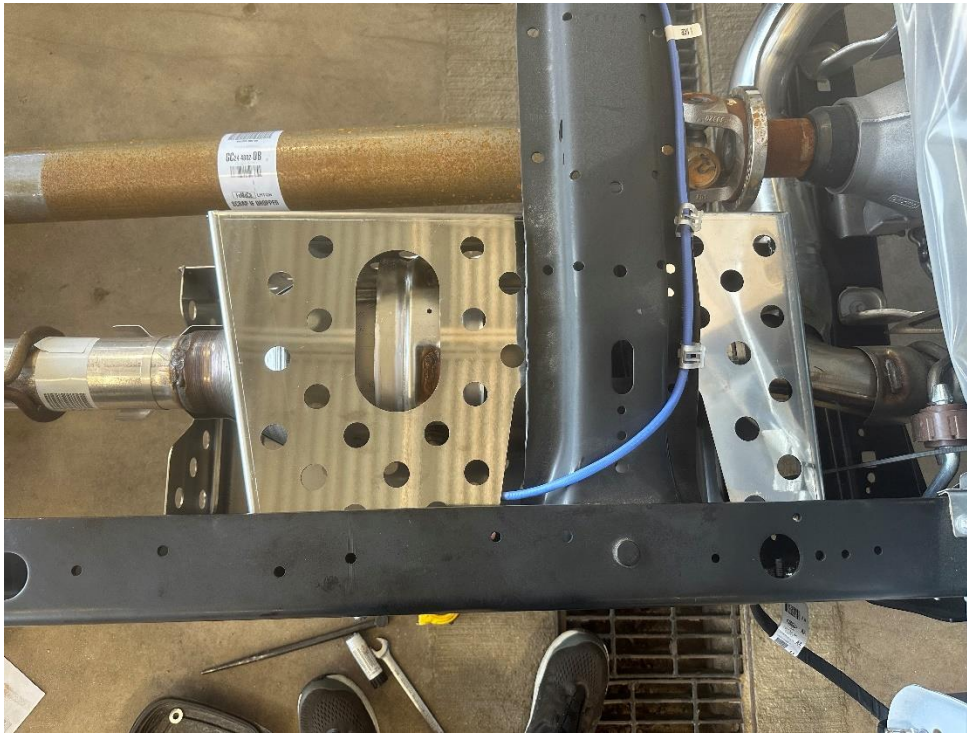

Figure 5

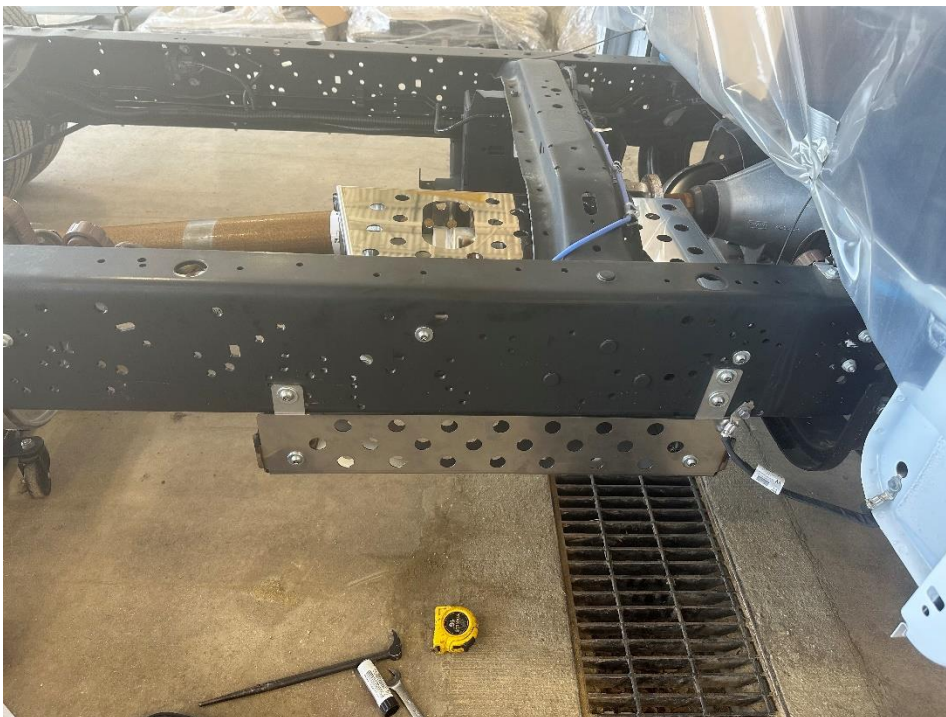

Figure 6

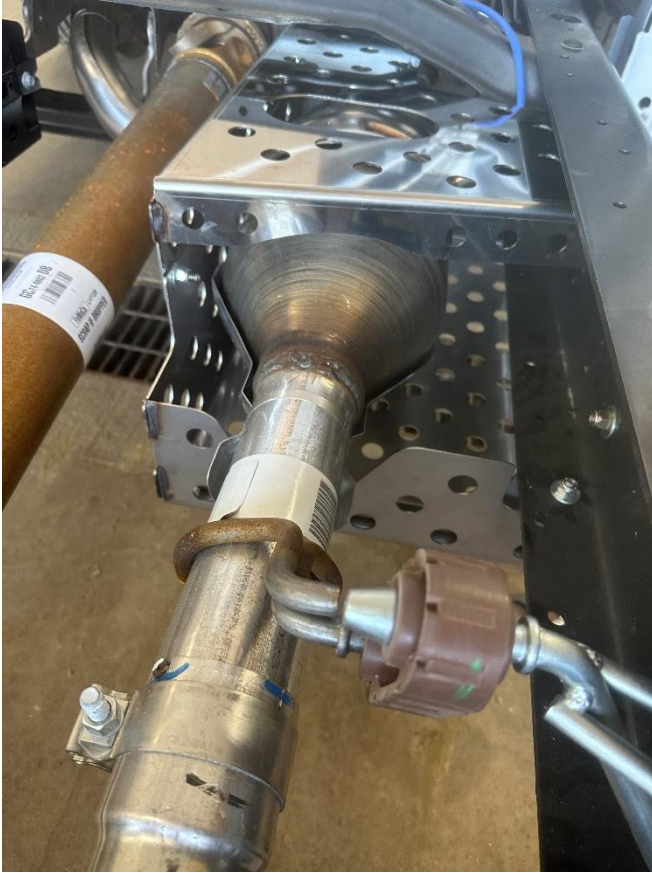

Figure 7